



CONTINUOUS BEAM FRAME

FRAME SYSTEMS



FEATURES

- Almost any width or height can be achieved and column locations can vary (along each frame and from frame to frame) to accommodate floor plan, equipment locations and rack systems
- Ridge design can be center ridge, off-center or single slope
- Interior columns provide economical structural options
- Works with either purlins or bar-joist secondary
- May be used with other wall systems including block, tilt-up or conventional steel

BENEFITS

- Most economical framing option when interior columns can be used
- Adaptable for variations in floor plan for office space, material storage and machinery placements
- Engineered to meet exact frame requirements for loads including mechanical loads, crane loads and mezzanine loads
- Options include center ridge, off-center or single slope to meet architectural appearance and roof drainage design

CONTINUOUS BEAM FRAME

Durable frame option with virtually any width, height and interior column placement

If your building plan allows interior columns, VP can provide a quality structure at lower cost with our Continuous Beam frame.

Continuous Beam frames can be designed for center ridge, off-center ridge or single slope. Roof pitch can be as low as 1/4:12. With Continuous Beam frames, virtually any width or eave height can be achieved.

VP's custom concept approach to design allows builders to use Continuous Beam framing in conjunction with other VP framing systems (such as Open Web or Rigid Frame) to provide owners the most economical solution. Continuous Beam frames can also be used with other systems including block, tilt-up, or conventional steel framing.

This high strength 55 KSI steel primary framing system consists of straight or tapered sidewall columns and 3-plate interior columns, with options for pipe and tube columns, to support loads across the entire width of the building. Interior column spaces can reach 100' or more in increments of 1/16".

Continuous Beam frames can be designed to accept almost any specified snow and wind loads and crane loads. Works well with either purlins or bar-joist. Any girt placement can be utilized, including flush-mount, inset or outset. Materials are factory coated with a rust inhibitor primer. Frames arrive ready to erect and paint.

Backed by industry leading warranty for material and workmanship.



TYPICAL CONTINUOUS BEAM FRAME

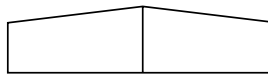
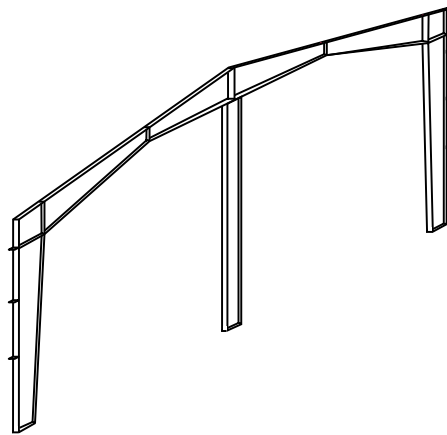

CB-1

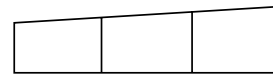

CB-2 (SINGLE SLOPE)



CB-3 (OFF CENTER RIDGE)

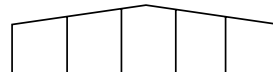

CB-4



Varco Pruden Buildings, 3200 Players Club Circle, Memphis, TN 38125

©All rights reserved. Varco Pruden Buildings® is a division of BlueScope Buildings North America, Inc. Varco Pruden meets or exceeds the most comprehensive testing and compliance standards in the building system industry. To learn more about our products, services and qualifications, visit our website, www.vp.com. **Building Solutions... one relationship at a time.**

2052 Continuous Beam
Issue Date: 2003
Revised: 8/16